

Plexineon[®] Recessed Mount System

PRODUCT SUMMARY

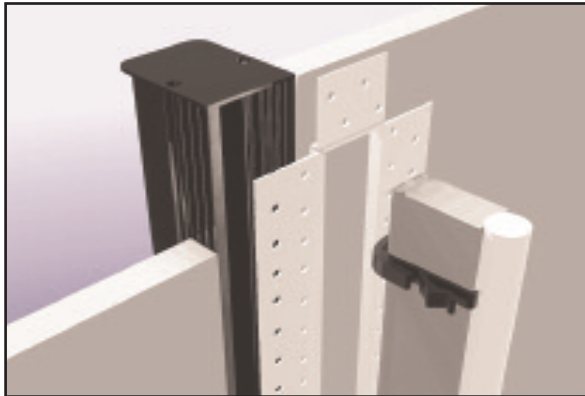

PRODUCT FEATURES

- For use with any Plexineon[®] product
- Plexineon[®] is adjustable from exposed to semi-recessed to fully-recessed (flush) positions
- Adaptable to a wide range of constructions
- Easy rough-in installation
- Ceiling or wall mount
- Flush plaster trim or direct grout finishing
- Snap-in clips allow for easy fixture installation without disturbing surrounding surfaces

Recessed Housing

- Aluminum extrusion, black anodized finish
- Standard straight 8' (2438mm) length
- Field cuttable
- Continuous runs can be created with interlocking alignment pins
- Screw-on end plates included for each run
- For straight runs only, not for use with any field or factory bent fixtures

Universal Mounting

- Suited for steel frame and wood stud mounting
- Internal screw guide for attachment to mounting surface
- Adaptable for stone, marble and concrete installations
- Not intended for in-ground use

Wire Entry

- Housing to be drilled in the field for use with provided strain relief
- Adaptable for conduit fitting (not included)

Paint Mask

- Paint mask provided to protect housing interior during construction and wall finishing

Finishing Options

- Flush plaster trim provides seamless appearance in drywall and allow for clean fixture installation
- Direct grout finishing for concrete, stone or marble installations

Fixture Installation

- Specialty snap-in nylon clips provided
- Spacer pads provided for linear (end to end) spacing

Selectable Fixture Positioning

- Snap-in nylon clips attach to Plexineon[®] and allow three selectable fixture positions: exposed, semi-recessed and fully recessed (flush)
- Fixture adjustment tool provided

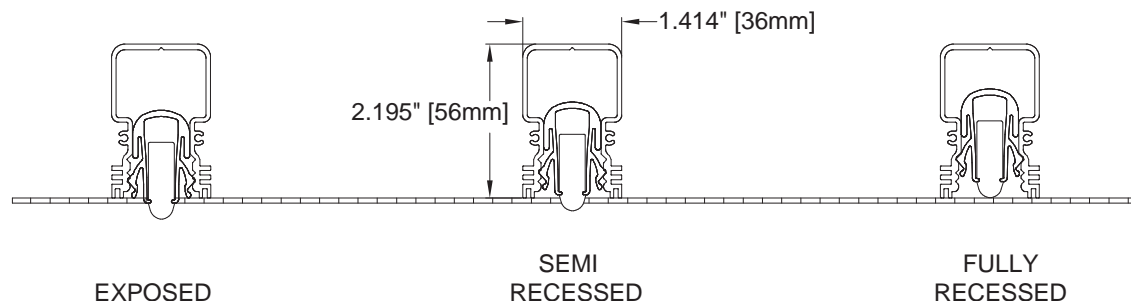

ORDERING INFORMATION

Order number: 75-EXT01-001-00
Order number: 35-EXT01-001-00

Recessed Housing Extrusion
Recessed Housing Flush Plaster Trim